

WATER HEATER PARTS

| BULK NO. | CTN. QTY. | DESCRIPTION | CARDED NO. | CTN. QTY. |
|----------|-----------|-------------|------------|-----------|
|----------|-----------|-------------|------------|-----------|

Drip Pans & Accessories

| | | | | |
|---------|---|--|--|--|
| 40-0050 | 1 | Bottom or side drain drip pan • 30 & 40 gal. Capacity • Styrene | | |
| 40-0100 | 1 | Bottom drain drip pan • 30 & 40 gal. Capacity • Aluminum | | |
| 40-0110 | 1 | Side drain drip pan • 30 & 40 gal. Capacity • Aluminum | | |
| 40-0120 | 1 | Bottom drain drip pan • 50 gal. Capacity • Aluminum | | |
| 40-0130 | 1 | Side drain drip pan • 50 gal. Capacity • Aluminum | | |
| 40-0140 | 1 | Drain drip pan stand • 50 gal. Capacity | | |
| 40-0908 | 1 | Plastic drain drip pan adapter only 1" MPT x 1" Female slip | | |



40-0050



40-0100



40-0110



40-0130

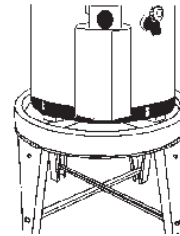

40-0140

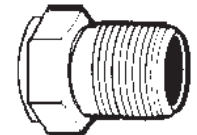

40-0908

Insulation Jackets

| | | | | |
|---------|---|------------------------------|--|--|
| 40-1750 | 1 | 30-60 gal. Size • Rated R-8 | | |
| 40-1754 | 1 | 30-60 gal. Size • Rated R-12 | | |
| 40-1752 | 1 | 60-100 gal. Size • Rated R-8 | | |

Water Heater Enclosures

Heavy galvanized steel • Meets all plumbing code requirements • No special equipment or training needed • Installs with minimum effort • Can be assembled with screwdriver

| | | | | |
|---------|---|--|--|--|
| 40-0201 | 1 | 20, 30, or 40 gal. Capacity • Less back • 24" Square x 72½" Tall | | |
| 40-0220 | 1 | 50, 75, or 100 gal. Capacity • Less back • 30" Square x 72½" Tall | | |



40-1750
thru
40-1754

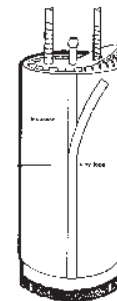

40-0201
40-0220



IMMERSION ELEMENTS

UL Listed • Parts & Instructions Included

Note: All elements are high watt density elements (150+ watts per square inch) unless otherwise indicated.

* indicates low watt density elements (75+ watts per square inch)

** indicates medium watt density elements (100 + 150 watts per square inch)



| BULK NO. | CTN. QTY. | MINIMUM TANK DIAMETER | CARDED NO. | CTN. QTY. |
|----------|-----------|-----------------------|------------|-----------|
|----------|-----------|-----------------------|------------|-----------|

Round Head Elements

Grooved for bracket • Fits State water heaters manufactured prior to July 1975.

| | | | | |
|---------|---|--------------------------|--|--|
| 40-1104 | 1 | 8" • 1500 W • 120 Volts | | |
| 40-1122 | 1 | 14" • 4500 W • 240 Volts | | |



Screw In Elements • 1-1/4 THREAD

| | | | | |
|----------|---|--------------------------|---------|---|
| 40-1010 | 1 | 8" • 1000 W • 120 Volts | | |
| | | 8" • 1500 W • 120 Volts | 40-1015 | 1 |
| 40-1018 | 1 | 8" • 1750 W • 120 Volts | | |
| 40-1022 | 1 | 8" • 2000 W • 240 Volts | | |
| 40-1024 | 1 | 10" • 2500 W • 240 Volts | | |
| 40-1028 | 1 | 12" • 3500 W • 240 Volts | | |
| | | 14" • 4500 W • 240 Volts | 40-1031 | 1 |
| | | 9" • 4500 W • 240 Volts | 40-1033 | 1 |
| *40-1036 | 1 | 10" • 1500 W • 120 Volts | | |
| | | 14" • 4500 W • 240 Volts | 40-1045 | 1 |
| *40-1046 | 1 | 16" • 6000 W • 240 Volts | | |
| | | 12" • 5500 W • 240 Volts | 40-1049 | 1 |



Screw In Elements • 1-3/8 THREAD

| | | | | |
|---------|---|--------------------------|---------|---|
| | | 14" • 4500 W • 240 Volts | 40-1151 | 1 |
| 40-1160 | 1 | 14" • 4500 W • 240 Volts | | |



IMMERSION ELEMENTS CONTINUED

| BULK NO. | CTN. QTY. | MINIMUM TANK DIAMETER | CARDED NO. | CTN. QTY. |
|----------|-----------|-----------------------|------------|-----------|
|----------|-----------|-----------------------|------------|-----------|

Flat Flange Elements

| | | | | |
|---------|---|--|---------|---|
| 40-1204 | 1 | 8" • 1500 W • 120 Volts | | |
| 40-1220 | 1 | 14" • 4500 W • 240 Volts | | |
| | | 9" • 4500 W • 240 Volts | 40-1223 | 1 |
| 40-1224 | 1 | 14" • 4500 W • 240 Volts • Low watt density • 75 Watts per PSI | | |

National® Brand

| | | | | |
|---------|---|--------------------------|--|--|
| 40-1228 | 1 | 14" • 4500 W • 240 Volts | | |
|---------|---|--------------------------|--|--|

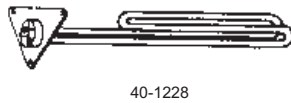

Universal Flange

| | | | | |
|---------|---|--------------------------|---------|---|
| 40-1250 | 1 | 8" • 1000 W • 120 Volts | | |
| 40-1254 | 1 | 8" • 1500 W • 120 Volts | | |
| | | 14" • 4500 W • 240 Volts | 40-1271 | 1 |
| | | 9" • 4500 W • 240 Volts | 40-1273 | 1 |
| 40-1276 | 1 | 14" • 4500 W • 240 Volts | | |

Lime-Life™ Elements • Deluxe

| | | | | |
|---------|---|---|---------|---|
| 40-1292 | 1 | 15¼" • 4500 W • 240 Volts Universal style | | |
| | | 15¼" • 4500 W • 240 Volts Screw-in style | 40-1303 | 1 |



ELEMENT ACCESSORIES

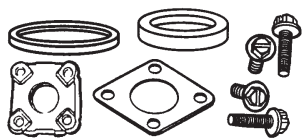

40-1500

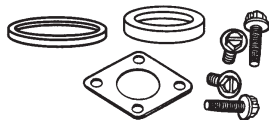

40-1512



40-1530



40-1532



40-1536



40-1540



40-1542



40-1544

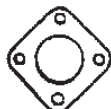

40-1548



40-1522

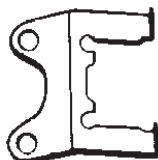

40-1526

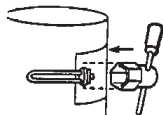

40-1600

| BULK NO. | CTN. QTY. | DESCRIPTION | CARDED NO. | CTN. QTY. |
|----------|-----------|-------------|------------|-----------|
|----------|-----------|-------------|------------|-----------|

Adapt-A-Flange Kits

Includes flange, gasket, and instructions

| | | | | |
|---------|---|--|--|--|
| 40-1500 | 1 | Universal adapter kit • Converts screw-in to replace round head, flat, and universal flange • Gasket & metal flange washer kit | | |
| 40-1512 | 1 | Same as above • Without metal flange | | |

REPLACEMENT BASKETS

| | | | | |
|---------|---|---|---------|---|
| 40-1530 | 1 | Round head element gasket • 1-5/8" O.D. x 1-1/8" I.D. • 3/16" Thick | | |
| 40-1532 | 1 | Screw-in element gasket • 1-1/2" O.D. x 1-1/4" I.D. • 1/8" Thick | 40-1533 | 1 |
| 40-1536 | 1 | 4 Bolt flat flange round gasket • 1-5/8" O.D. • 1/2" Thick | 40-1537 | 1 |
| 40-1540 | 1 | Gasket • Fits National water heater | | |
| 40-1542 | 1 | Moulded round head gasket • 1-5/8" O.D. • 3/16" Thick | | |
| 40-1544 | 1 | Round 4 bolt universal gasket • 1-5/8" O.D. • 5/16" Thick | | |
| 40-1548 | 1 | Four hole gasket | | |

Element Self-Tapping Screws

| | | |
|---------|---|-------------------------|
| 40-1522 | 1 | 1/2" Self-tapping screw |
|---------|---|-------------------------|

Thermostat Brackets

| | | |
|---------|---|--------------------|
| 40-1526 | 1 | Thermostat bracket |
|---------|---|--------------------|

Element Wrench

| | | | | |
|---------|---|---------------------------|---------|---|
| 40-1600 | 1 | Heavy duty element wrench | 40-1601 | 1 |
|---------|---|---------------------------|---------|---|



WATER HEATER THERMOSTATS

| BULK NO. | CTN. QTY. | DESCRIPTION | CARDED NO. | CTN. QTY. |
|----------|-----------|------------------------------------|------------|-----------|
| | | Model #CM-5 • Single pole | 40-1621 | 1 |
| | | Model #CM-6HL • Combo type | 40-1627 | 1 |
| | | • Double pole | | |
| 40-1632 | 1 | Thermodisc upper thermostat w/HLC | | |
| 40-1636 | 1 | Thermodisc lower thermostat | | |
| | | • Single pole | | |
| 40-1638 | 1 | Thermodisc thermostat • Combo type | | |
| | | • Single pole | | |
| | 1 | Single element thermostat disc | 40-1639 | 1 |



Water Heater Accessories

| | | | | |
|---------|---|---|----------|---|
| | | Water heater installation kit heater • Includes earthquake wall brackets | 40-1710P | 1 |
| | | M/W water heater installation kit | 40-1712P | 1 |
| 40-1000 | 1 | Dielectric water heater heat trap • 1Pair | | |
| 40-0900 | 1 | Water Inlet Dip Tube • Flared • Fits 3/4" top inlet water heaters | | |
| | | Water heater drain valve • 3/4" MIP x 3/4" Male hose | 40-0905 | 1 |
| 40-0906 | 1 | Water heater dielectric nipple • 3" Over all length • 3/4" MPT both ends • Bulk sold per each • Carded in pairs | 40-0907 | 1 |
| | | Water heater drain valve • 5/8 Shank | 40-0911 | 1 |
| 40-0990 | 1 | Water heater dielectric heat trap nipple • 1" MPT x 1" Female slip • Carded in pairs | | |

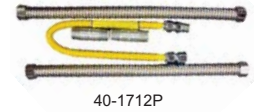
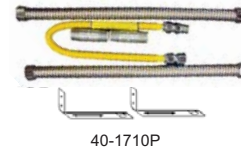

WATER HEATER ACCESSORIES CONT'D

| BULK NO. | CTN. QTY. | DESCRIPTION | CARDED NO. | CTN. QTY. |
|----------|-----------|--|------------|-----------|
| | | 7 Foot water heater strap kit • 30/40/50 Gallon capacity | 40-1721 | 1 |
| | | 10 Foot water heater strap kit • 100 Gallon capacity | 40-1725 | 1 |
| 40-1726 | 1 | 2" x 10' Heavy duty water heater strap • 22 Gauge | | |
| 40-1730 | 1 | Holdrite #50 water heater strap | | |
| 40-1732 | 1 | Spacemaker Bearclaw water heater strap | | |
| 40-1734 | 1 | Spacemaker wrap around water heater strap | | |
| 40-1736 | 1 | Firefighter Front-wrap water heater strap | | |
| 40-1700 | 1 | Earthquake water heater bracket 1-1/8" Holes accomodate 3/4" IPS • Fits up to 50 gal. heater | | |

Continuity Tester

| | | |
|---------|---|--|
| 40-1642 | 1 | Water heater continuity tester |
| 36-1140 | 1 | Gas water heater control with energy cut-off |

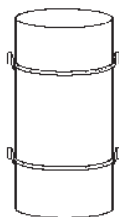

40-1721
40-1725



40-1726



40-1732



40-1726



40-1730



40-1732

40-1734

40-1734



40-1736

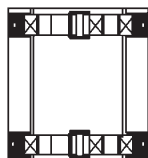

40-1736

40-1700

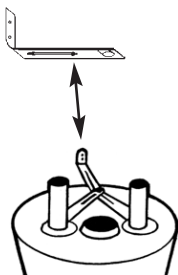

40-1700

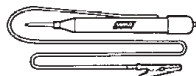

40-1642

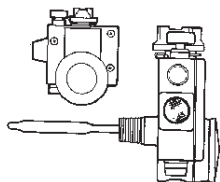

36-1140

